

TOWMASTER[®] TRAILERS

MODELS:
T-50RG
T-70RG

The Standard for the Road Ahead!

Some equipment shown may be optional



Optional triple axle available on the RG.



Two-way spring-assist is standard.



S.A.E. King Pin with smooth approach plate for easy hook-up.

Description:

The Towmaster[®] T-50RG and T-70RG Rigid Gooseneck trailers are ready to haul your heavy equipment behind your fifth-wheel tractor. They feature dual axles, two-way spring-assist ramps, Hutchens suspension and sealed wiring. A 10-foot top deck can haul a skid-loader or other smaller equipment (optional loading ramps required). A triple axle is available on the T-70RG.

Quick Specs:

- 36" deck height (empty)
- 8'-6" deck width
- 20'-0"/22'-0" deck w/10'-0" top deck
- Air brakes
- Hutchens[®] suspension
- Adjustable hitch
- Two-way spring-assist ramps
- LED lights and sealed wiring

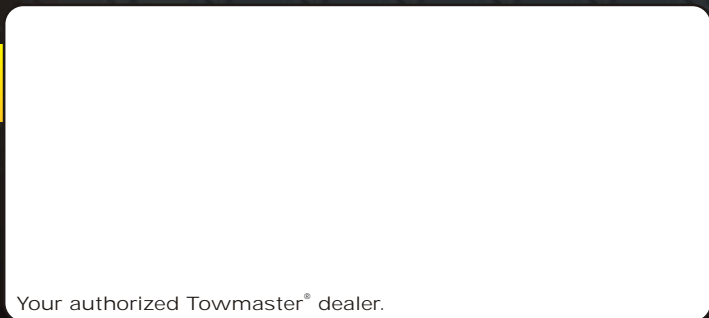

Your authorized Towmaster[®] dealer.

Towmaster, Inc.

800-462-4517

Fax: 320-693-7921

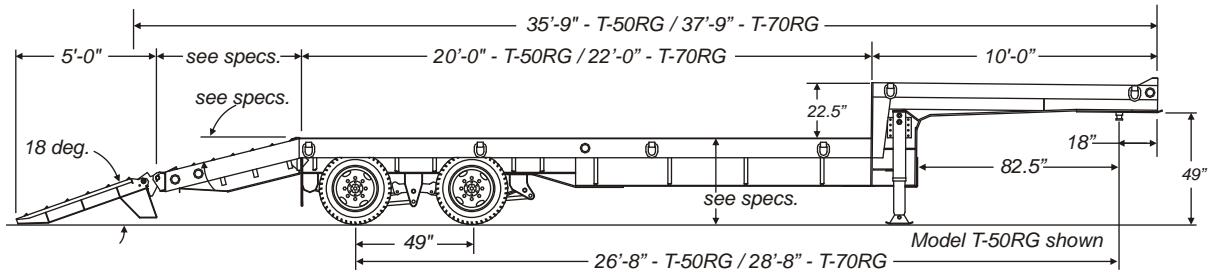

SPECIFICATIONS					
S=Standard O=Optional					
CAPACITY / DIMENSIONS		T-50RG	T-70RG		
Axle/Wheel Capacity Rating (lbs/kg)		50,000 / 22,680	70,000 / 31,751		
Approx. Weight (lbs/kg)		11,500 / 5216	15,680 / 7112		
Deck Height (empty) (in/mm)		36 / 914	36.5 / 927		
Deck Length (ft-in/mm)		20-0 / 6096	22-0 / 6706		
Overall Width (ft-in/mm)		8-6 / 2591	8-6 / 2591		
Overall Length (ft-in/mm)		35-9 / 10,896	36-9 / 11,201		
GOOSENECK					
Top Deck Length (ft-in/mm)		10-0 / 3048	10-0 / 3048		
Swing Clearance (in/mm)		82.5 / 2096	82.5 / 2096		
Truck Height (in/mm)		49 / 1245	49 / 1245		
Adjustable Hitch		N/A	N/A		
S.A.E. King Pin		S	S		
25K Bolt-on Two-Speed Parking Jack		S (2)	S (2)		
FRAME / RAMPS					
Main Beam (up to 24')		W16 x 26 Grade 50	Mfg. Cambered		
Main Beam (25'+)		Mfg. Cambered	Mfg. Cambered		
High-Tensile 3" Jr. I-beam Crossmembers		S	N/A		
W6 x 9 Beam Crossmembers		N/A	S		
Crossmembers 16" on-center		S	S		
Headboard (top deck) (in/mm)		3 / 76	3 / 76		
Channel Side Rails (in/mm)		8 / 203	10 / 254		
2" Nominal Oak Wood Deck		S	N/A		
Full 2" Oak Wood Deck		O	S		
Wood Protectors		S	S		
Tie Downs		Forged D-rings	Forged D-rings		
Number of Tie-Downs (Total / Side)		12 / 6	12 / 6		
Beavertail (ft-in / mm) (angle-degrees)		5-0 / 1524 (14)	4-0 / 1219 (16)		
Ramps (ft-in x in/mm)		5-0 x 21 / 1524 x 533	5-0 x 21 / 1524 x 533		
Two-Way Spring Assist		S	S		
SUSPENSION / TIRES					
Hutchens Spring Suspension		S	S		
Dexter Axles (number of axles)		S (2)	S (2)		
Axle Capacity (each) (lbs/kg)		22,500 / 10,206	25,000 / 11,340		
Oil Bath Hubs		S	S		
Air Brakes		S	S		
Brake Size (in/mm)		12.25x7.5 / 311x191	12.25x7.5 / 311x191		
Budd-type Wheels (in/mm)		17.5x6.75 / 445x171	17.5x6.75 / 445x171		
Wheels Hub Piloted		S	S		
Wheel Bolt Pattern		8-bolt	8-bolt		
Tires / Load Range Rating		215/75R x 17.5 / H	235/75R x 17.5 / H		
Poly Mud Flaps		S	S		
WIRING / FINISH					
Weather Resistant Sealed Wiring		S	S		
Weather Resistant Lights		S	S		
L.E.D. Lights		S	S		
Registration Holder		S	S		
Rust Inhibiting Primer		S	S		
Durable, Rust Resistant Top Coat		S	S		
Durable, Die-Cut UV Resistant Vinyl Decals		S	S		
Subject to F.E.T.		Y	Y		
Follow local and Federal D.O.T. laws, including Federal Motor Carrier Safety Regulations §392.9, §393.100 and §393.102, and stay within GVWR restrictions.					
OPTIONS					
Additional deck length Additional tie downs Third axle on T-70RG 8'-0" overall width 6'-0" beavertail w/6'-0" ramps (not on T-70RG)	Double-break beavertail (not on T-70RG) Special color (no metallic) Spare tire and wheel Spare tire carrier Stake pockets and rub rail	Winch and cable Outriggers Angelim Pedra wood deck 30-degree neck (adds 40" to deck length) Aluminum ramps to load top deck			

We manufacture a complete line of trailers in capacities from 2000 lbs. to 120,000 lbs. Listed weights are approximate. Trailer weights can vary due to options installed. All dimensions are approximate. See VIN tag for actual GVWR. Check our website or see your authorized dealer for more information. Manufacturer reserves the right to modify, change or discontinue models or options as seen fit without obligation to previously sold units. Written warranty covers each trailer.

Towmaster, Inc., 61381 US Hwy 12, Litchfield, MN 55355
Toll free: 800-462-4517 phone: 320-693-7900 fax: 320-693-7921
www.towmaster.com
Employee Owned, Employee Pride, U.S.A. Made!
U.S.A. DESIGNED AND BUILT

Photos may not show most recent changes to models.