

TOWMASTER[®] TRAILERS

MODELS:
T-5T, T-5TSL

The Standard for the Road Ahead!

Some equipment shown may be optional



Positive locking (over-center) latch system keeps deck secured to the frame.



Low tilt angle to easily load small equipment.



The T-5TSL includes the "SL" (Scissor Lift) option with ramps to lower the loading incline.

Description:

The T-5T is a pan type tilt-deck trailer designed for hauling small equipment. The deck features white oak wood and 7-inch high sides. The low deck height offers a shallow tilt angle that allows small equipment to easily climb the incline. For scissor lifts, an "SL" option adds ramps for an even lower load angle. The T-5T features a rubber-ride axle for a smooth ride, electric brakes, an adjustable hitch, and a positive locking (over-center) latch system to safely keep the deck secured to the frame.

Quick Specs:

- 16.5" deck height (empty)
- 77" deck width
- Pan style deck
- Electric brakes
- Torflex[®] axle
- Adjustable hitch
- Positive latch system
- LED lights and sealed wiring

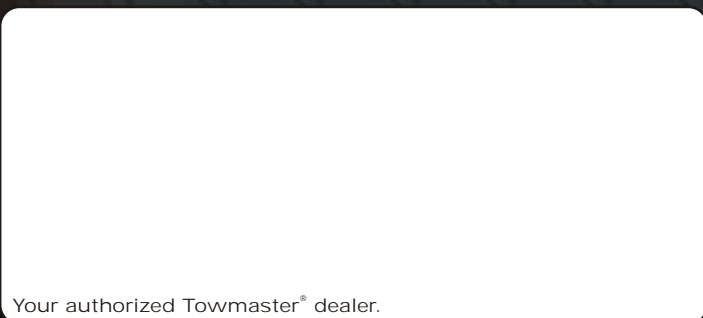

Your authorized Towmaster[®] dealer.

Towmaster, Inc.



800-462-4517

Fax: 320-693-7921

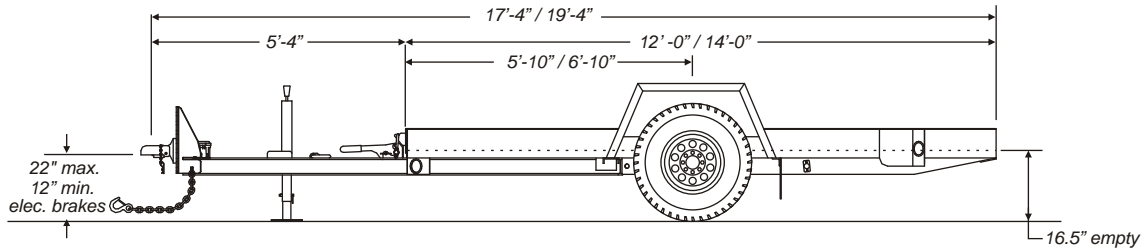

SPECIFICATIONS					
S=Standard O=Optional					
CAPACITY / DIMENSIONS		T-5T	T-5TSL		
Capacity Rating (lbs/kg)		5,000 / 2268	5,000 / 2268		
Approx. Weight (12'-0" / 3658mm)(lbs/kg)		1,950 / 884	1,950 / 884		
Approx. Weight (14'-0" / 4267mm)(lbs/kg)		2,100 / 952	2,100 / 952		
Deck Height (empty)(in/mm)		16.5 / 419	16.5 / 419		
Overall Width (ft-in/mm)		8-6 / 2591	8-6 / 2591		
Load Width (in/mm)		77 / 1956	77 / 1956		
TONGUE					
Tongue Length (ft-in/mm)		5-4 / 1626	5-4 / 1626		
Adjustable Hitch		S	S		
3" Pintle Ring or 2-5/16" Ball Coupler		Specify	Specify		
3/8" High-Tensile Safety Chain x 40"		Grade 43	Grade 43		
Storage Tray		N/A	N/A		
Bolt-on Drop-Leg Parking Jack		7K	7K		
FRAME / RAMPS					
Main Beam		M4 x 13 beam	M4 x 13 beam		
High-Tensile 3" Jr. I-beam Crossmembers		S	S		
Crossmembers 16" on-center		S	S		
Headboard (in/mm)		7 / 177	7 / 177		
Side Rails (in/mm)		7 / 177	7 / 177		
Oak Wood Floor / Pan Deck		S	S		
Over-center Deck Latch		Single Point	Single Point		
Tilt Angle (12'-0" deck - degrees)		11	7		
Tilt Angle (14'-0" deck - degrees)		9.5	6		
Ramps (ft-in/mm)		N/A	3-0x16 / 1219x406		
Auto-Latch® Ramp Hold-ups		N/A	S		
Tie Downs		Forged D-rings	Forged D-rings		
Number of Tie-Downs (Total / Side)		6 / 3	6 / 3		
SUSPENSION / TIRES					
Dexter Torflex® Rubber-Ride Axle w/5-Year Warranty		S	S		
Axle Capacity (lbs/kg)		7,000 / 3175	7,000 / 3175		
Hubs		E-Z Lube®	E-Z Lube®		
Electric Brakes		S	S		
Brake Size (in/mm)		12x2 / 305x51	12x2 / 305x51		
Battery Break-Away Kit w/Charger		S	S		
Wheels (in/mm)		15x6 / 381x152	15x6 / 381x152		
Wheel Bolt Pattern		8-bolt	8-bolt		
Tires / Load Range Rating		ST225/75R x 15 / D	ST225/75R x 15 / D		
Poly Mud Flaps		S	S		
WIRING / FINISH					
Weather Resistant Sealed Wiring		S	S		
Weather Resistant Lights		S	S		
LED Lights		S	S		
6-pole Round or 7-pole RV Electrical Plug		Specify	Specify		
Registration Holder		S	S		
Rust Inhibiting Primer		S	S		
Durable, Rust Resistant Top Coat		S	S		
Durable, Die-Cut UV Resistant Vinyl Decals		S	S		
Follow local and Federal D.O.T. laws, including Federal Motor Carrier Safety Regulations §392.9, §393.100 and §393.102, and stay within GVWR restrictions.					
OPTIONS					
Hydraulic surge brakes w/free backing (Check local D.O.T. laws)		Spare tire/rim			
235/85R x 16 wheels and tires for 6,000 lb. capacity		Spare tire carrier			
Steel pan deck		Stake pockets and rub rail			
Deck cushion cylinder		Winch and cable			
Rubber runner pads		Angelim Pedra wood deck			
Additional tie downs					

We manufacture a complete line of trailers in capacities from 2000 lbs. to 120,000 lbs. Listed weights are approximate. Trailer weights can vary due to options installed. All dimensions are approximate. See VIN tag for actual GVWR. Check our website or see your authorized dealer for more information. Manufacturer reserves the right to modify, change or discontinue models or options as seen fit without obligation to previously sold units. Written warranty covers each trailer.

Towmaster, Inc., 61381 US Hwy 12, Litchfield, MN 55355
 Toll free: 800-462-4517 phone: 320-693-7900 fax: 320-693-7921
 www.towmaster.com
 Employee Owned, Employee Pride, U.S.A. Made!
 U.S.A. DESIGNED AND BUILT

Photos may not show most recent changes to models.